



PFM100S-15-1000

DC MILITARY FILTER

(E.G. MIL-STD-461, DO-160, ETC.)

SPECIFICATIONS

MAX VOLTAGE: 0-500VDC

MAX CURRENT: 15A/LINE

OPERATING TEMP.: -40 TO 70C

HIPOT (L-G): 1800VDC

TYP. WEIGHT, LB(KG): 0.45(0.2)

MANUFACTURED IN ACCORDANCE WITH

THE FOLLOWING STANDARDS:

UL1283

MIL-STD-220

MIL-F-15733

LV DIRECTIVE

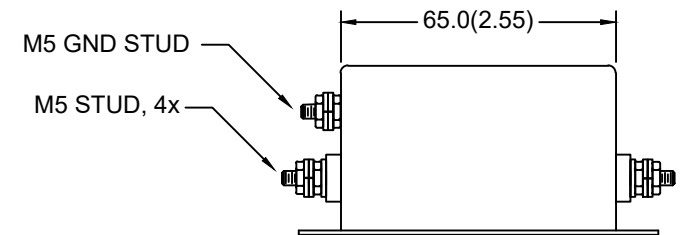
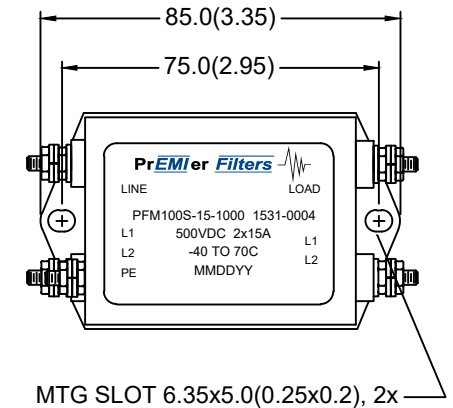
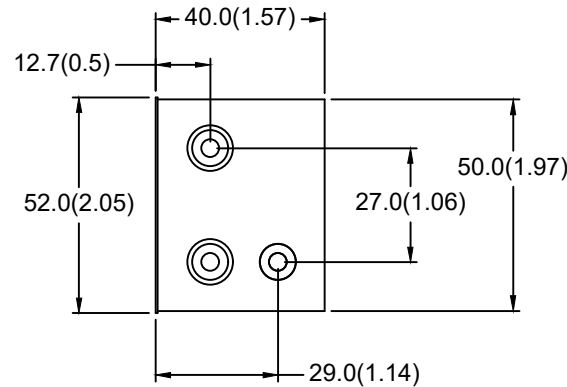

| TYPICAL INSERTION LOSS, 50/50 OHM | | | | | |
|-----------------------------------|-----|------|------|----|-----|
| FREQ(HZ) | 10K | 100K | 500K | 1M | 10M |
| CM,dB | 28 | 40 | 60 | 65 | 55 |
| DM, dB | 24 | 42 | 61 | 60 | 42 |

SPECIFICATIONS SUBJECT TO CHANGE